

Castle2

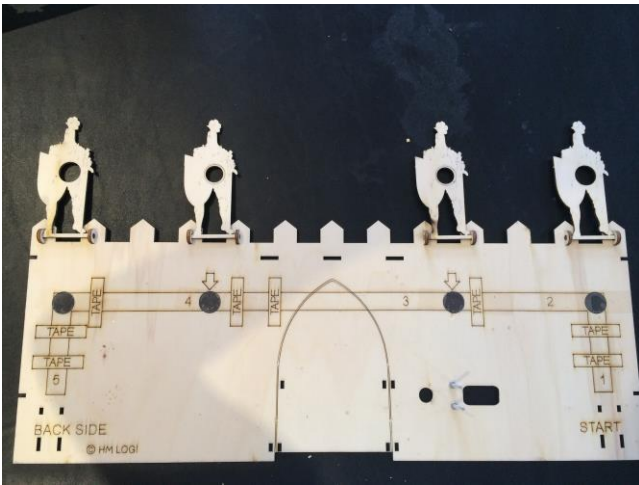

Before starting, check all the steps from the previous lesson.

After doing so, assemble the remaining 3 knights the same way we did the first one.

Make sure all the knights are facing the same way

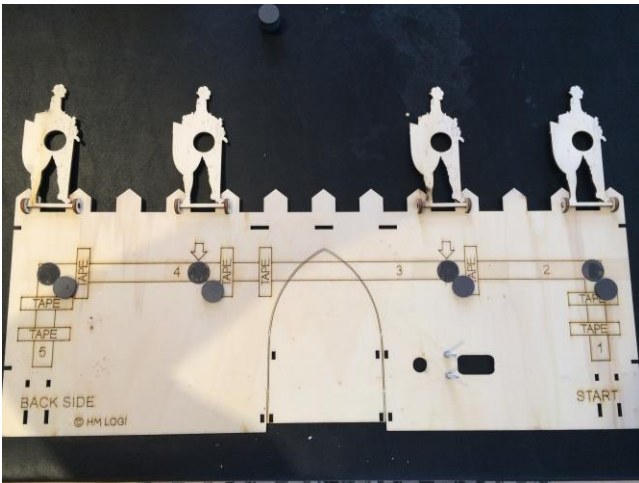

Once done, hand the students 4 magnets.

Make sure the screws are facing up.

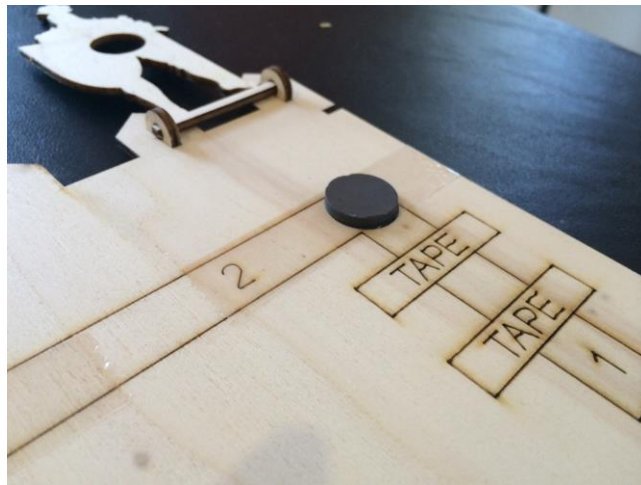
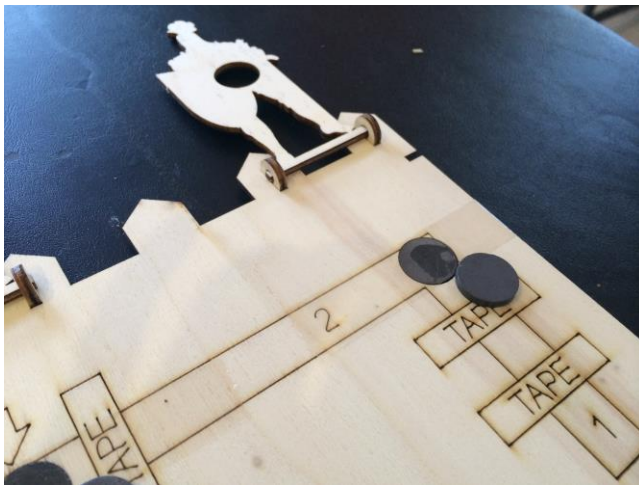

Magnet each one to the magnets we taped earlier. **DO NOT TAPE THESE MAGNETS YET!**

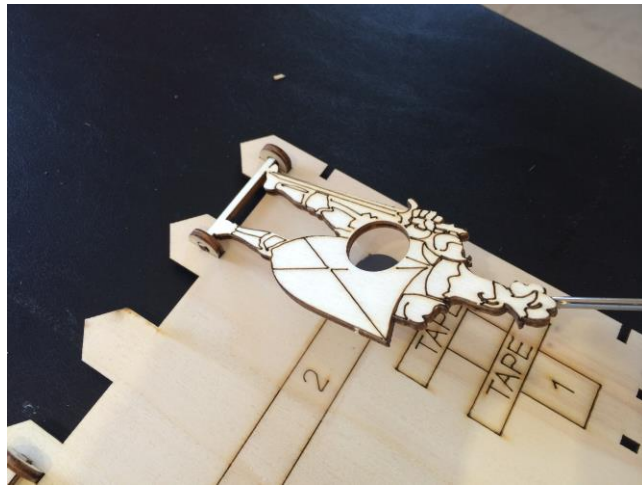
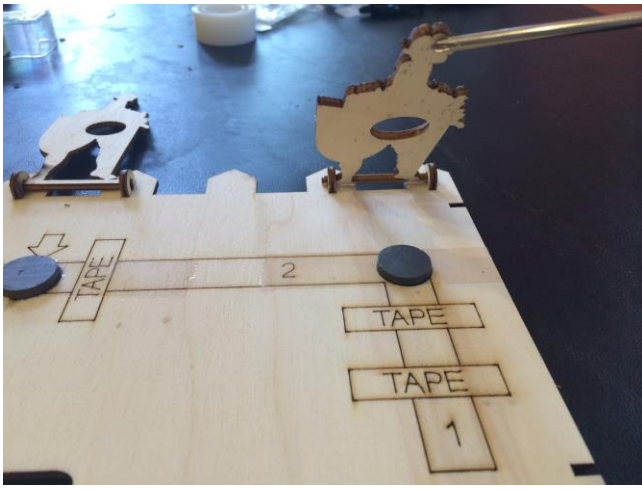

If all the magnets are in their spots, flip the knight backwards onto the magnet.



Make sure the magnet is inserted all the way and is centered.

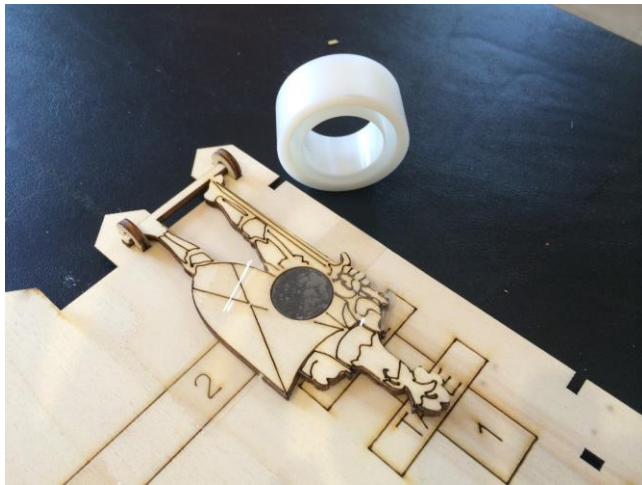

Make sure the magnet sits in the middle of the knight's chest. Then take a piece of tape and tape the magnet onto the knight's front side



Then, lift the knight, and use another piece of tape to tape the magnet to the knight's rear side.

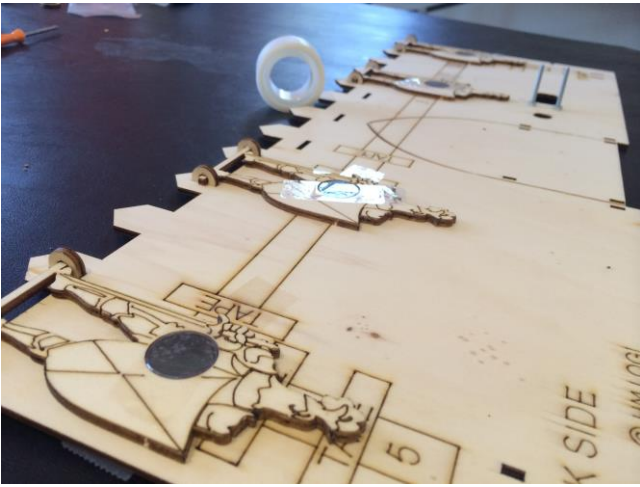

Do the same for all 4 knights

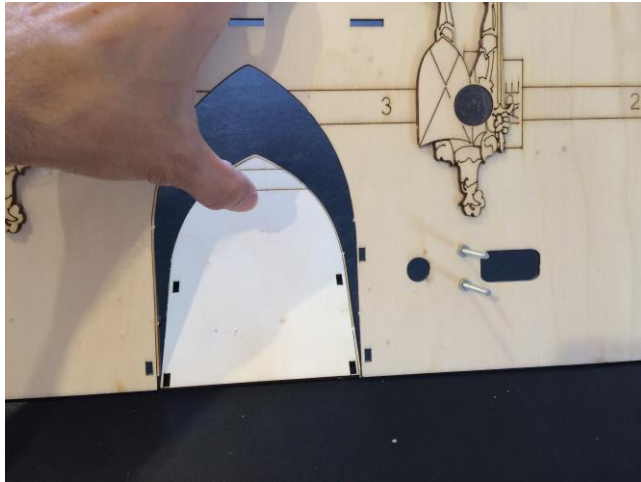
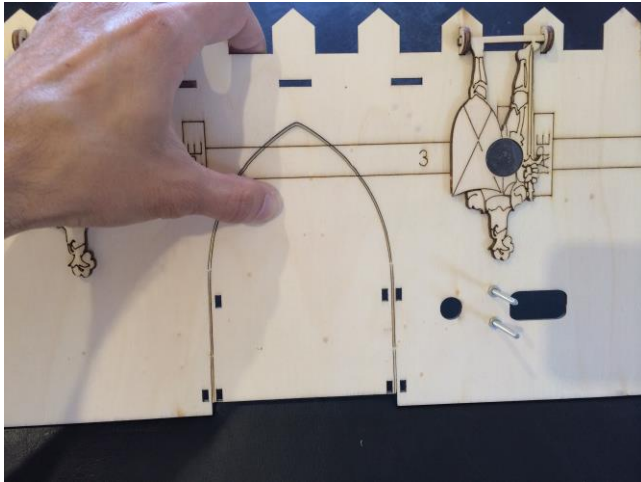

Carefully, pop out the door.

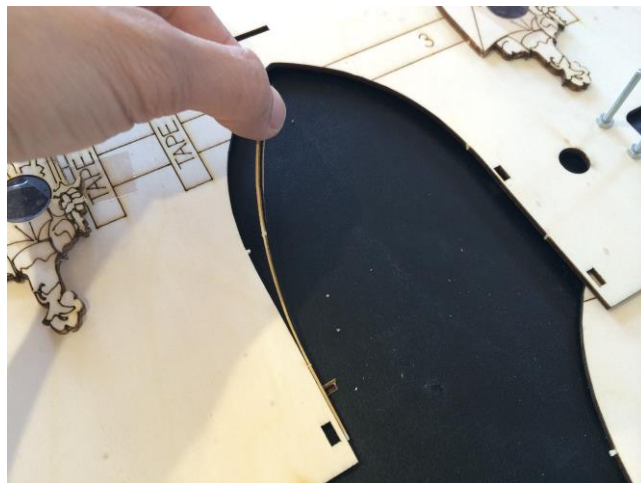
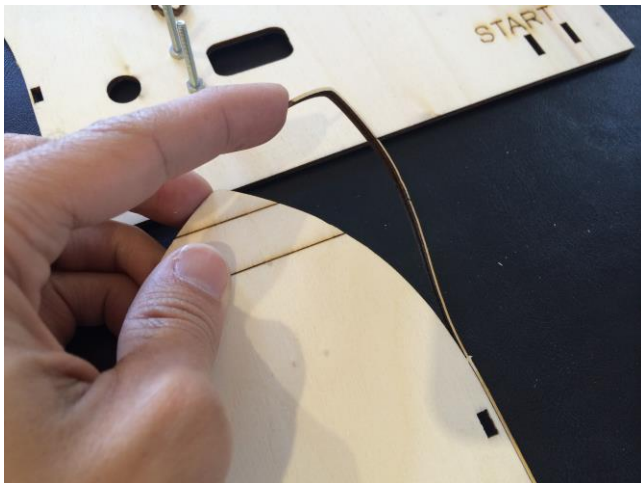

Break all left over part from the gate.
If you have enough time, file down the gate with the students

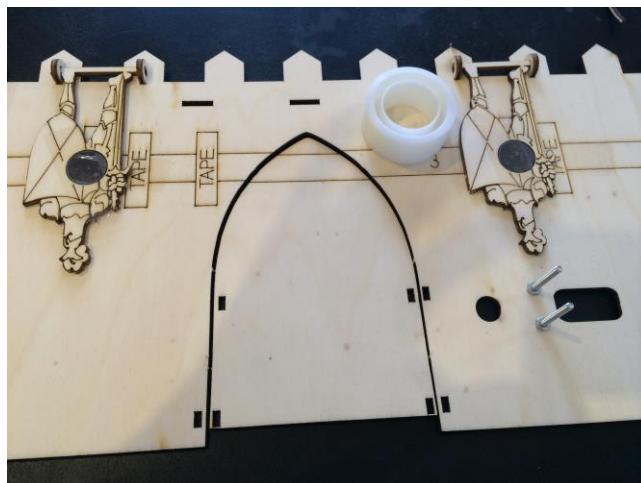

After cleaning the unnecessary parts, place the gate back into its place

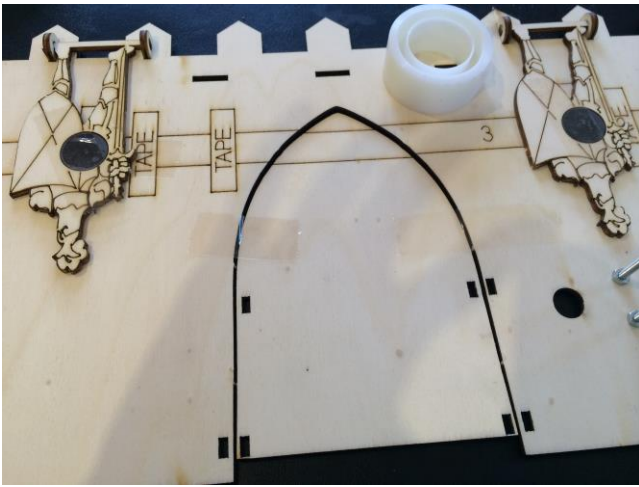

Use enough tape on both side of the gate to hold it in place.

Flip the castle and tape the gate from the front as well.